

TECHNICAL DATA



CONCEPT :

The K pumps are waste water submersible pumps. They are specially designed to handle very heavy and abrasive slurries containing fibrous materials.

These centrifugal pumps, with single canal impeller, feature a totally new patented agitator. This agitator, directly fixed on the impeller, integrates the inlet of the pump and prevents any rotation blockage.

The impeller, the suction cover and the agitator are manufactured in cast chrome iron (24 to 28% Cr).

A strong short shaft, made of stainless steel, sustained by a series of carefully selected bearings, transmits the rotation speed of the motor to the upper side of the impeller. The design of the pump offers a large passage.

The tightness of the pump is secured by a two level mechanical seal system. A double mechanical seal, working in oil bath, constitutes a first barrier, in the oil chamber. A second mechanical seal, at the entrance of the detection chamber, constitutes the second barrier. This chamber is equipped with a moister sensor.

The powerful electric motor (F class) is designed to be cooled by the liquid, in which the pump is submerged, as well as by the air, in case of low liquid level. This makes pumping operations, with low water level, possible. Thermal protection is standard.

K pumps are available in different metallurgies and/or with detachable bend and base.

OPERATING CONDITIONS :

- Slurries with solids contents of up to 50% in weight
- Particle sizes up to 70 mm
- Liquid temperatures up to 60°C
- pH level between 4 and 14

Special versions are available for liquid temperatures up to 80°C. The maximum operating depth is 30m.

ELECTRIC POWER REQUIREMENTS* :

Model	Power kVA	Amp. 400 V
K 3	6	5
K 5	12	8
K 7.5B	15	11.8
K 10	20	15.3
K 15	30	23
K 20	40	28
K 30	50	41
K 40	65	58

*The figures are indicative.

ELECTRIC CABLE :

The standard cable type to be used for connecting the pump is HO7RN-F. Its specifications should correspond to :

Model	Section	Outer diam. mm	Max. length m / 400V
K 3	4 x 6 mm ²	17	500
K 5	4 x 6 mm ²	17	350
K 7.5B	4 x 6 mm ²	17	240
K 10	4 x 6 mm ²	17	180
K 15	4 x 10 mm ²	22	190
K 20	4 x 10 mm ²	22	160
K 30	4 x 16 mm ²	25	170
K 40	4 x 35 mm ²	34	260

CONTROL PANEL :

For 3 to 10 HP K pumps, we recommend the use of a Toyo control panel equipped with direct starter. From 15 HP pumps on, we recommend the use of a Toyo control panel with statoric starter.

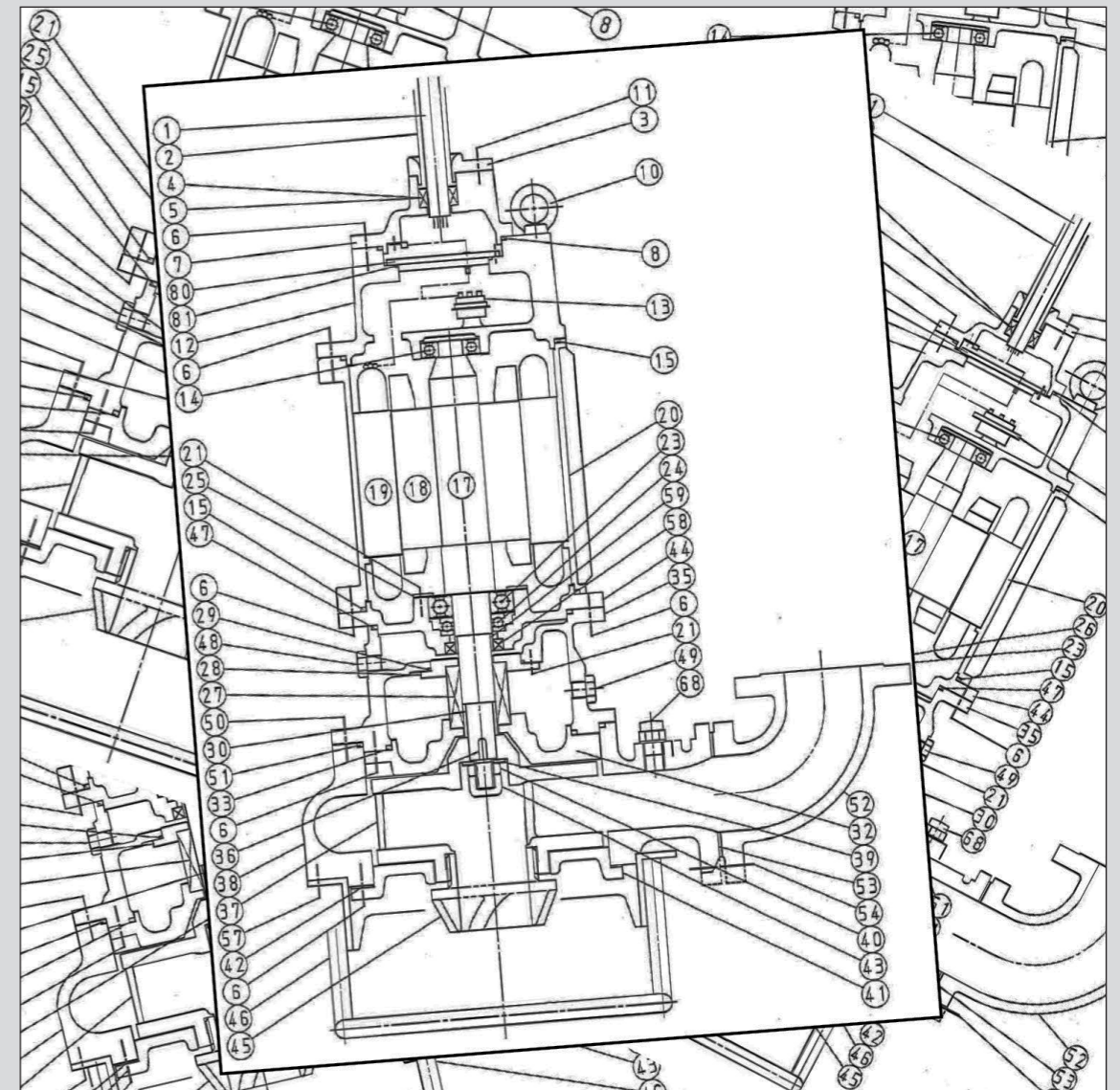

Heavy slurry pumps

**TECHNICAL SPECIFICATIONS
K PUMPS**



Performance curves

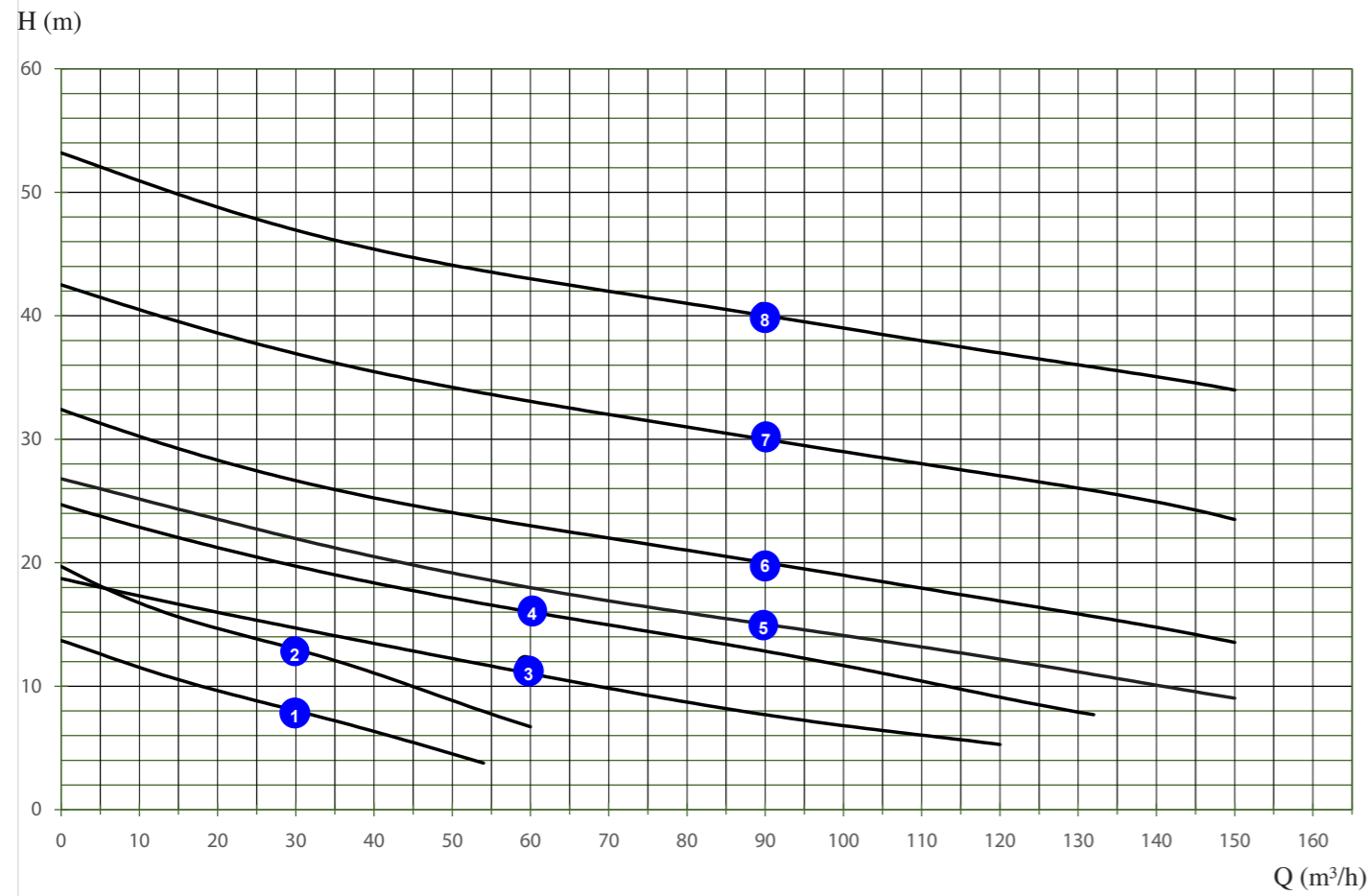

Nr	Type	Outlet (inch) (mm)	Capacity (m³/h)	Manom. head (m)	Particle size (mm)	Power (kW)	Poles (P)	Revolution (1/min) 50Hz	Current (A) 400V	Electr. cable	Weight (kg)
1	K 3	3 80	30	8	56	2.2	4	1430	5	4 x 6 mm²	175
2	K 5	3 80	30	13	56	3.7	4	1460	8	4 x 6 mm²	185
3	K 7.5B	4 100	60	11	70	5.5	4	1480	11.8	4 x 10 mm²	245
4	K 10	4 100	60	16	70	7.5	4	1450	15.3	4 x 10 mm²	265
5	K 15	4 100	90	15	70	11	4	1480	23	4 x 10 mm²	355
6	K 20	4 100	90	20	70	15	4	1480	28	4 x 10 mm²	395
7	K 30	4 100	90	30	70	22	4	1470	41	4 x 16 mm²	770
8	K 40	4 100	90	40	70	30	4	1480	58	4 x 35 mm²	1000

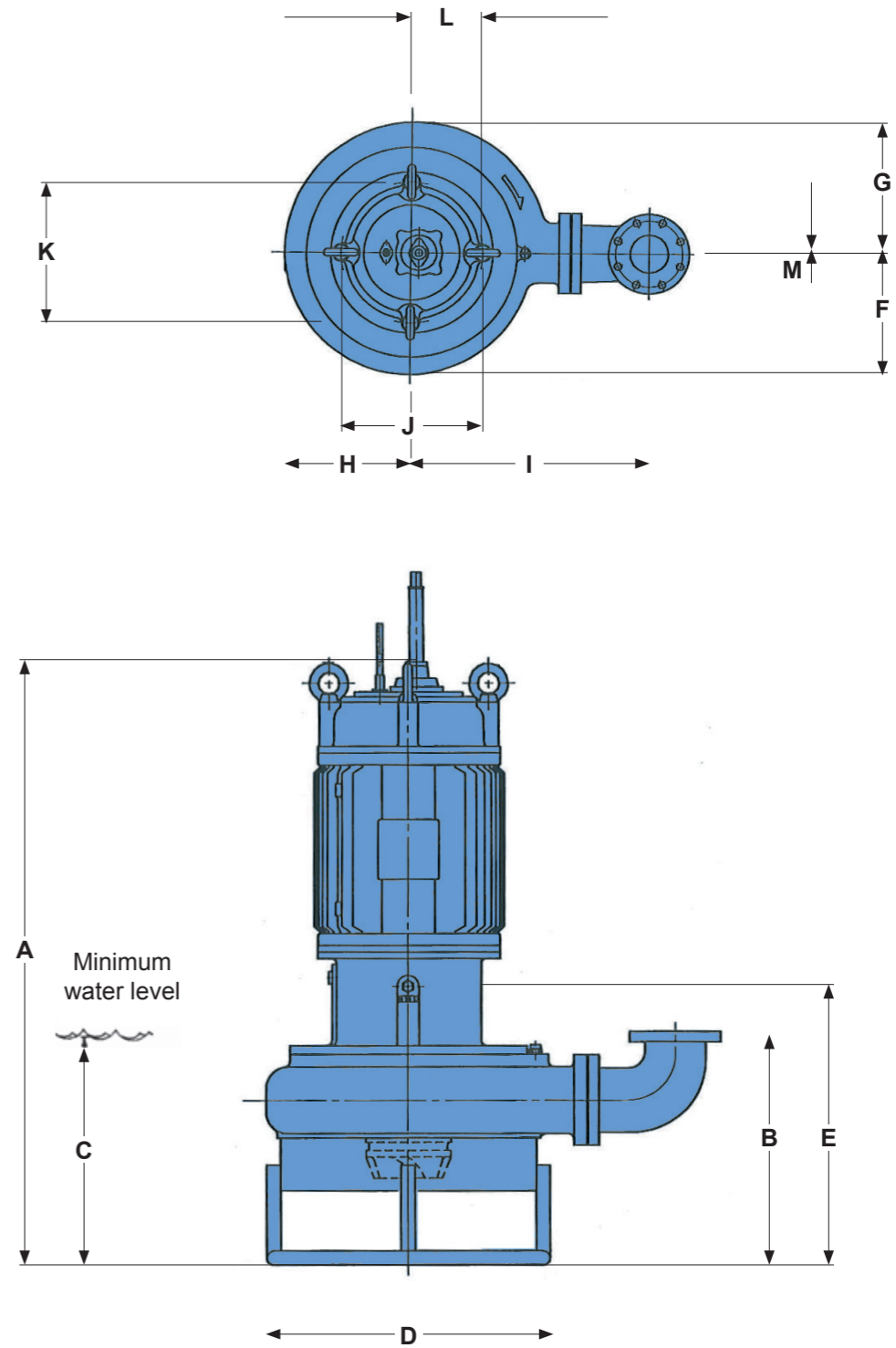

DIMENSIONS (mm)		A	B	C	D	E	F	G	H	I	J	K	L	M
1	K 3	919	375	350	357	196	215	196	363	363	200	200	78	9
2	K 5	939	375	350	357	196	215	196	363	363	200	200	78	9
3	K 7.5B	1009	426	380	384	228	248	238	443	443	220	220	90	9
4	K 10	1063	426	380	384	228	248	238	443	443	220	220	90	9
5	K 15	1227	490	450	451	251	271	261	478	478	277	320	86	13
6	K 20	1296	490	450	451	251	251	261	478	478	277	320	86	13
7	K 30	1442	548	580	658	320	340	330	618	618	370	370	88	11
8	K 40	1657	548	580	658	320	340	330	618	618	370	370	88	11